

Part Number
HDLGBS28

## Big Valley Packaging

(520) 988-3002  
 www.BigValleyPackaging.com  
 Support@BigValleyPackaging.com

### Product Image

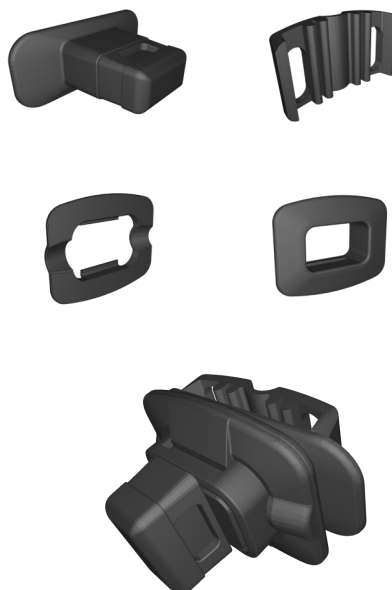

Product Description	
Item Name	Twist Lock GBS
Size	1.16" (L) x 0.94"(W)
Carton Thickness	0.04"-0.06"
Material	POM
Ordering Information	
HDLGBS2810	White
HDLGBS2880	Black
Packaging Information	
Carton Pack/MOQ	2500 pcs/ctn.
Carton Weight	27 lbs.

### Product Dimensions

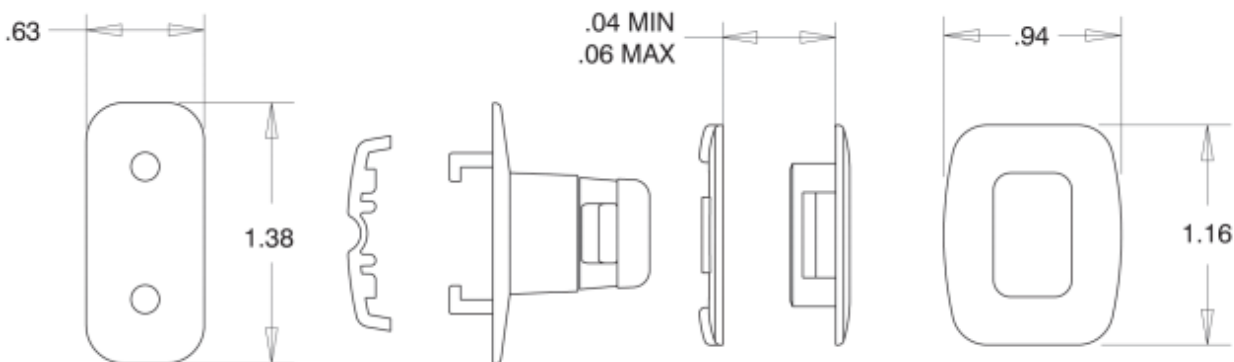

### Die-Cut Dimensions

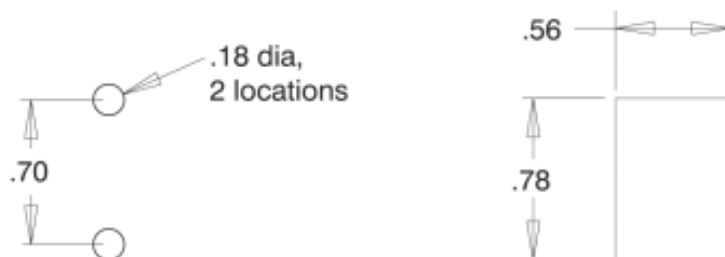



# Big Valley Packaging

(520) 988-3002  
www.BigValleyPackaging.com  
Support@BigValleyPackaging.com

# Instruction Sheet

Part Number
HDLGBS28
Product Name
Twist Lock

## Product Images



## Installation Procedure

① Make appropriate die cuts on the inner and outer panels.

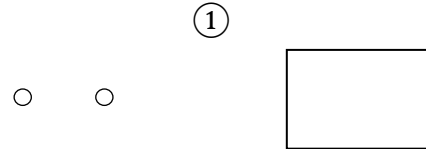

② Align the twist lock front and its rear plate with the die-cut. Snap to lock in place.

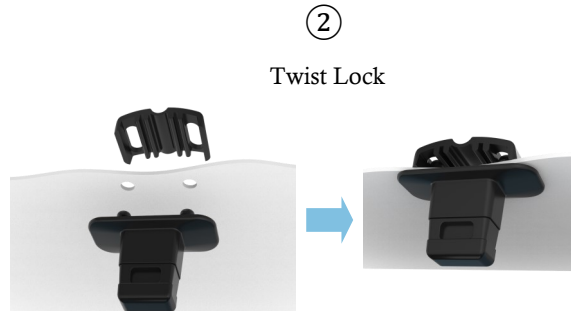

③ Align the rectangular fitting front and its rear plate with the die-cut. Snap to lock in place.

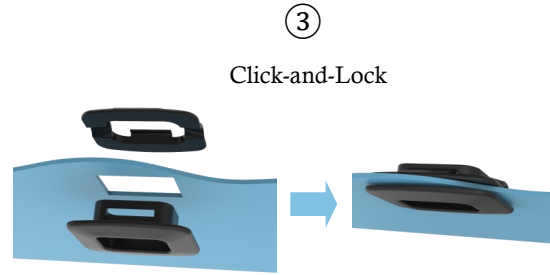

④ Insert the twist lock into the rectangular fitting. Twist 90 degrees to lock in place.

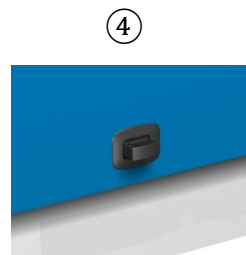

\*\*\* This product is designed for .04”-.06” panel thickness.